

**CHANGE THE FACE OF
ARCHITECTURE™**



LONGBOARD®
ARCHITECTURAL PRODUCTS

Exterior Catalogue



Light National Walnut • T & G • 6" V Groove

Anodic Ice • T & G • 6" V Groove

We believe that inspiring architecture is the result of thoughtful design, premium products, and quality workmanship. That's why we create easy to love architectural solutions using the highest-quality materials.

Designed for time saving install, our AAMA 2604/2605 powder coated systems give you peace of mind when facing exterior elements including corrosion and UV rays. We make everything in-house, starting from aluminum extrusion and ending with finishing touches, packaging, and shipping to site.

We invite you to experience the Longboard® difference as together we will Change the Face of Architecture™.





Dark Cherry •
T & G •
6" V Groove

Light Fir •
T & G •
6" V Groove

Dark National
Walnut •
T & G •
6" V Groove

Why choose Longboard



Fire Safety

The Longboard systems are inherently fire safe because they are manufactured from 100% non-combustible materials.



Durability

Extruded aluminum have a high impact strength. Longboard offers only the highest-grade architectural powder coating finishes complying with AAMA 2604 and AAMA 2605.



Sustainability

All Longboard products have life cycle information and EPDs available showing environmental, economical, and social responsible life cycle impacts.



We Own the Production Process

We don't outsource any of our manufacturing, extrusion, powder coating or finishing.



Longboard has compiled and documented a complete list of applicable LEED v4.1 credits for both its interior as well as exterior systems and can be used as guidance to apply for LEED credits on building projects.



Maintenance

Easy to maintain and cost effective field repairs. Dirt and debris can be easily rinsed and washed off with a mild detergent depending on frequency of build-up.



Rain-Screen

Drained and Back Ventilated (DBV) rain screen with mechanical seals, thus there is no need for caulking.



Ease of Installation

Regular cladding installers can quickly learn Longboard™ installation techniques. The systems are straight - forward in their application and cutting can be done on site.



Our Products are Ready to Ship

We produce most orders within 3-6 business days and have secured raw materials to meet large orders.



Dark National Walnut • T & G • 6" V Groove



Light Fir • T & G • 6" V Groove

LONGBOARD ECO™

We offer Longboard ECO™, a suite of products that contain recycled aluminum. Manufacturing these products results in less greenhouse gas emissions and generates less than 50% of the industry average embodied carbon.



6" Channel •
T & G •
Western Cedar

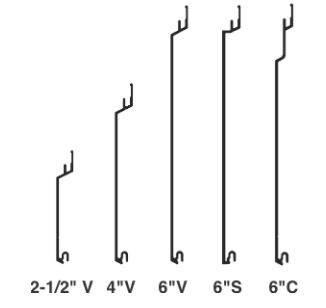
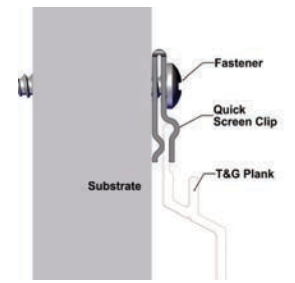
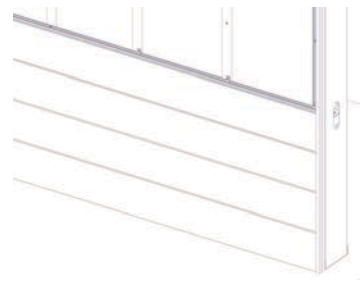

Plank Profiles
V-Groove: 2-1/2", 4", 6"
Smooth: 6"
Channel: 6"
Standard Lengths: 24'
96 SQ FT/box

Attachment
Planks: Quick-screen clips w. #8 screws* @ 32" o.c. (standard).
Quick-screen clips included: 135 pcs/4" box, 90 pcs/6" box.
Trims: hard fasten w. #8 screws* @ 16" o.c.
*Screws not included.

Finishes
Woodgrains, solid color, naturally aged metal, custom solid colour matching (additional lead times apply)

Component Trims
Standard Lengths: 12'

Lead Time
3-6 business days + shipping (subject to change)

BIM & CAD
RVT & DWG files available, see website for details

Rain Screen Cladding

Wall assemblies with drained and back-ventilated (DBV) rain screen cladding are becoming an increasingly popular choice across North America for architects, building science professionals, and building owners to construct sustainable high performance building enclosures.

These type of wall assemblies not only effectively deal with water and moisture, but also avoid radiant heat gain, accommodate continuous exterior insulation for improved thermal performance and improve IEQ (Indoor Environmental Quality).

Tongue & Groove

Applications: Cladding, Soffit & Panelboard

These 100% extruded architectural aluminum systems are available in visually striking woodgrains, solid colors, specialty finishes. Easy to install, non-combustible, and weather resistant, these systems are available in different plank dimensions with optional perforation solutions for vented applications.

Install is a easy using the supplied quick screen clips, and the system offers the versatility of horizontal or vertical application. May be installed on overhangs and onto furring strips or other framing systems where required.

Delivered in 12 or 24-foot lengths for easy install in the field or a pre-fabrication facility.

Technical Specifications

Physical Data

6063-T5 Extruded Aluminum
100% Recyclable
Warranty: Finish: 15 year (standard)/ 20 year* (ultra)
Aluminum: 50 year
Weight (lbs/sqft): ~1.5
(*10 week lead time)

Testing

ICC-ES Evaluation Report - Division: 07 00 00 Thermal and Moisture Protection Section: 07 46 00 - Siding
AAMA 509 Rainscreen: W1, V2
LARR - Los Angeles Department of Building Safety (LADBS) accepts ICC-ES reports as proof of compliance
Florida Product Code: FL20075 (Siding) and FL41776 (Soffitt)
Impact testing: TAS 201
WUI (The Wildland-Urban Interface) – California Department of Forestry & Fire Protection Office of the State Fire Marshal Listing No. 8140-2286:0500

Fire Rating: Class A Non-Combustible by ASTM E136 & ASTM E84 A2-s1,d0 by EN 13501-1

Wind load: Up to 121 psf (5794 Pa) TAS 202, TAS 203



Dark Cherry • T & G • 6" V Groove



National Walnut • T & G • 6" V Groove



Chilli Pepper • Panelboard • 6" Smooth
Black • Panelboard • 6" Smooth
Table Walnut • T & G • 6" V-Groove



Light Fir • T & G • 6" V Groove

Tongue & Groove Planks



V-Groove Planks

Size	12' *	24' *
2½"	3V.145	-
4"	4V.145	4V.289
6"	6V.145	6V.289



Smooth Planks

Size	12' *	24' *
6"	6PSP.145	6PSP.289



Channel Planks

Size	12' *	24' *
6"	6CH.145	6CH.289

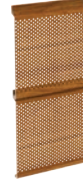

Perforated Planks

Size	12' *	24' *
6" V-Groove Plank	6VP.145	6VP.289
6" Smooth Plank	6SPP.145	6SPP.289

Component Trims

Starter



Precision Starter J-Track
Dimensions: (5/8") - 12'
SKU: 1SJT.145



Traditional Starter Strip
Dimensions: (1-7/8") - 12'
SKU: 1SJT.145



Traditional Back-to-Back Starter Strip
Dimensions: (1-7/8") - 12'
SKU: 1SJT.145

Compression Joint



Traditional Compression Joint
Dimensions: (1-3/8") - 24'
SKU: 2CJ.289

J-Track



Precision Two-Piece J-Track
Dimensions: (5/8") - 12'
SKU: 1X1JT.145



Precision J-Track
Dimensions: (5/8") - 12'
SKU: 1JT.145



Traditional Two Piece J-Track
Dimensions: (7/8") - 12'
SKU: JT23S.145



Traditional Two Piece J-Track
Dimensions: (1-3/8") - 12'
SKU: 1X2JT.145

Corner

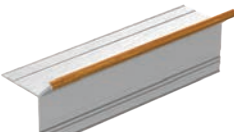

Precision Outside Corner
Dimensions: (3/16") - 12'
SKU: 05OC.145



Craftsman Inside Corner
Dimensions: (3/4") - 12'
SKU: 1IC.145



Craftsman Outside Corner
Dimensions: (1") - 12'
SKU: 1OC.145



Traditional Corner Set
Dimensions: (2") - 12'
SKU: 2CORS.145

Reveal



Precision Flat Reveal
Dimensions: (1/2") - 12'
SKU: 1FR.145



Precision T&G Flat Reveal
Dimensions: (1/2") - 24'
SKU: 1TGFR.289



Craftsman U-Reveal Set
Dimensions: (3/4") - 12'
SKU: 1URS.145



Craftsman T&G U-Reveal
Dimensions: (3/4") - 24'
SKU: 1TGURK.289



Traditional U-Reveal Set
Dimensions: (1-1/2") - 12'
SKU: 2URS.145



Traditional Flat Reveal Set
Dimensions: (1-1/2") - 12'
SKU: 2FRS.145



Traditional T&G U-Reveal
Dimensions: (1 1/2") - 24'
SKU: 2TGURK.289



Traditional Offset Flat Reveal Set, J-Track Base
Dimensions: (2") - 12'



Traditional Offset Flat Reveal Set, Termination Base

Termination



Craftsman Termination Set
Dimensions: (2") - 12'
SKU: 1TS.145



Traditional Termination Set
Dimensions: (7/8") - 12'
SKU: TS.145



Precision Termination Set
Dimensions: (1-3/8") - 12'
SKU: 2TS.145

Accessories



Quick Screen Clips
Qty: 1750, Box / 100, Bag
SKU: CLIP.N1750 / CLIP.N100



Touch Up Pens
SKU: TUP
Reach out to confirm color with an account manager



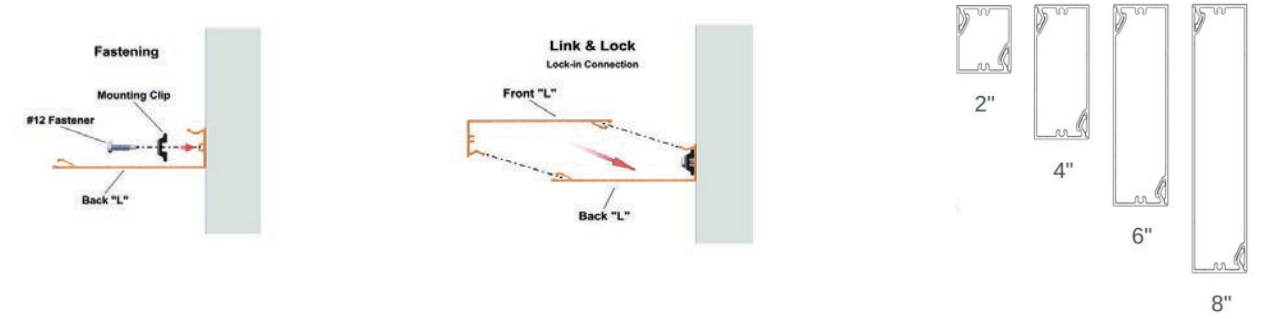
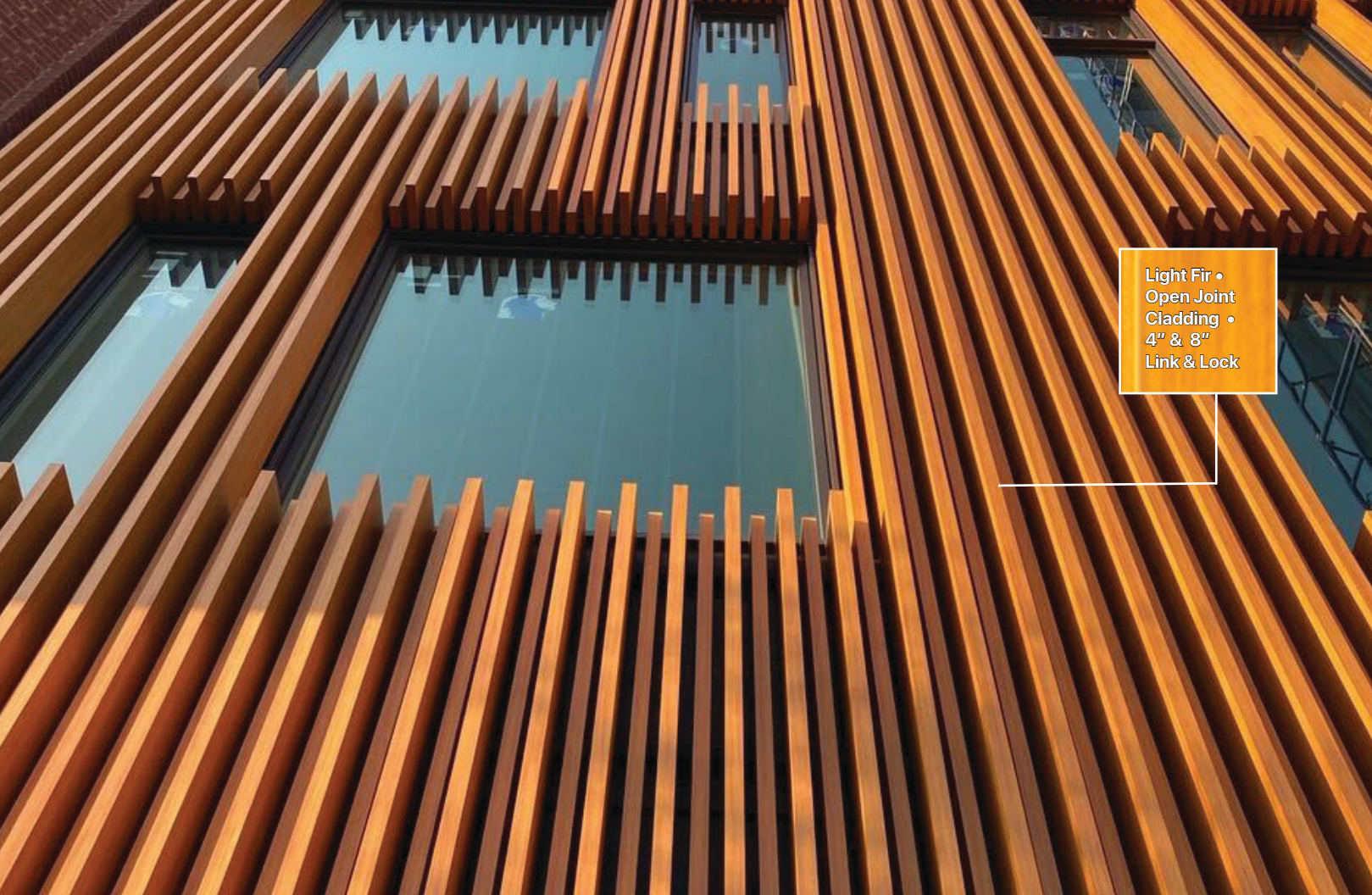

Profiles
1-5/8" x 2", 4", 6", 8"
Standard lengths: 24 ft

Attachment
Fasten w. #12 screws* @ 6' o.c.
Using mounting clips.
(*Not included)
See install guide for details.



Finishes
Woodgrains, solid color,
naturally aged metal, custom
solid colour matching (additional lead times apply)

Components
End Caps, Mounting Clips

Lead Time
3-6 business days + shipping (subject to change)

BIM & CAD
RVT & DWG files available,
see website for details

Battens

			Size	12'	24'	End Caps (20/box)	End Mounts (20/box)
			2"	2X2LL.145	2X2LL.289	2LLEC.2	2LLEM.2
			4"	2X4LL.145	2X4LL.289	2LLEC.4	2LLEM.4
			6"	2X6LL.145	2X6LL.289	2LLEC.6	2LLEM.6
			8"	2X8LL.145	2X8LL.289	2LLEC.8	2LLEM.8

Link & Lock™

Applications: Cladding, Soffitt, Screens & Enclosures.

Link & Lock™ is the innovative hidden fastener solution! The system was designed for easy install and creative adaptability in a variety of exterior applications. The Link & Lock™ aluminum batten system compliments any architectural design being non-combustible and weather resistant and uses matching Longboard end caps where needed to create a finished look.

The system is available in various dimensions and all woodgrain, solid color, naturally aged metal, and specialty finish options. These 2-piece battens can be installed in a variety of different ways and orientations to achieve beam, fin or louvre designs.

Technical Specifications

Physical Data

6063-T5 Extruded Aluminum
100% recyclable
Warranty: Finish:15 year (standard)/20 year* (ultra) Aluminum: 50 year
Weight (lbs/lf): 0.7 (1X3); 1.1 (1X5)
(*10 week lead time);

Testing

ICC-ES Evaluation Report - Division: 05 00 00 – METALS
• Section: 05 50 00 - Metal Fabrications
LARR - Los Angeles Department of Building Safety (LADBS) accepts ICC-ES reports as proof of compliance
International Building Code (IBC). International Residential Code (IRC)
California Building Code (CBC), California Residential Code (CRC)
City of Los Angeles Building Code (LABC)
City of Los Angeles Residential Code (LARC)
Florida Building Code – Building, Florida Building Code - Residential



Accessories

		
---	---	--

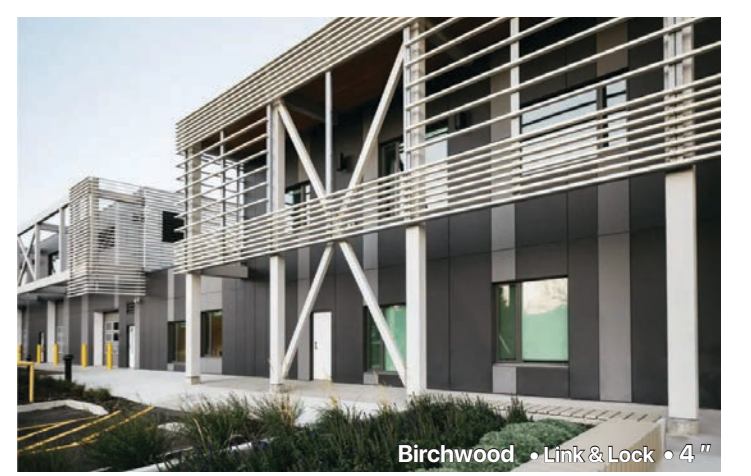
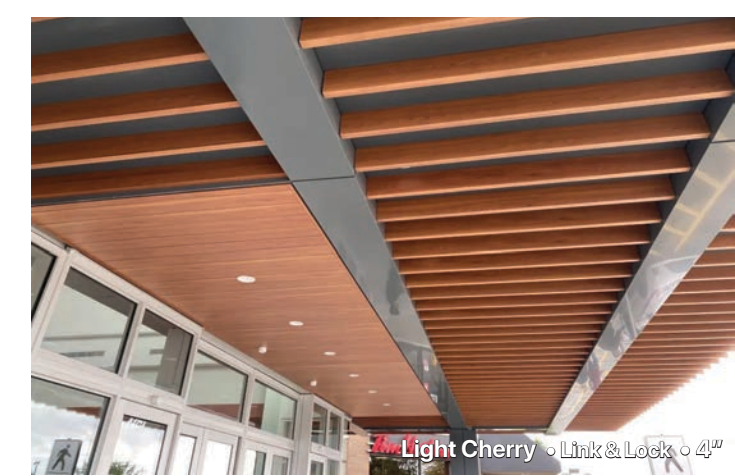



Dark Cherry •
Open Joint
Cladding •
1" x 3"
Privacy Beams

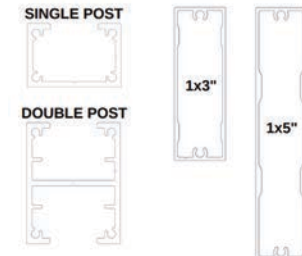
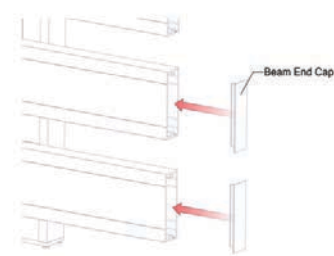

BEAM END CAP

Profiles
1x3", 1x5" - Standard Lengths: 24'

Components
Single Post, Double Post - Standard 24'L
Beam End Cap, Post End Cap - (20pcs)
Spacer Bar (1", 12'), Spacer Block
(100pcs)
Mounting Bracket - (100pcs)

Attachment
Floating System attached with Mounting
Brackets, End Frame System placed in posts and
supported with Spacer Blocks
Spacer Bar - comes in 12ft lengths -cut for
variable heights
Spacer Block - 1-1/2" spacer

Lead Time
3-6 business days + shipping (subject to change)

Finishes
Woodgrains, solid color,
naturally aged metal, custom
solid colour matching (additional lead times apply)

BIM & CAD
RVT & DWG files available,
see website for details

Privacy Beam

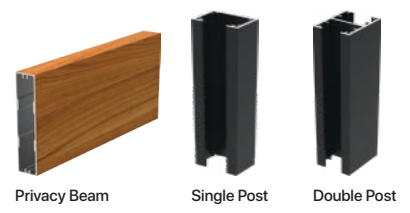

Size	Product	24'	End Caps (20/box)
1x3"	Privacy Beam	1X3B.289	1BEC.3
1x5"	Privacy Beam	1X5B.289	1BEC.5
2x2"	Privacy Post - Single	2X2SP.289	2X2PC.2
1x3"	Privacy Post - Double	2X3DP.289	2X3PC.3

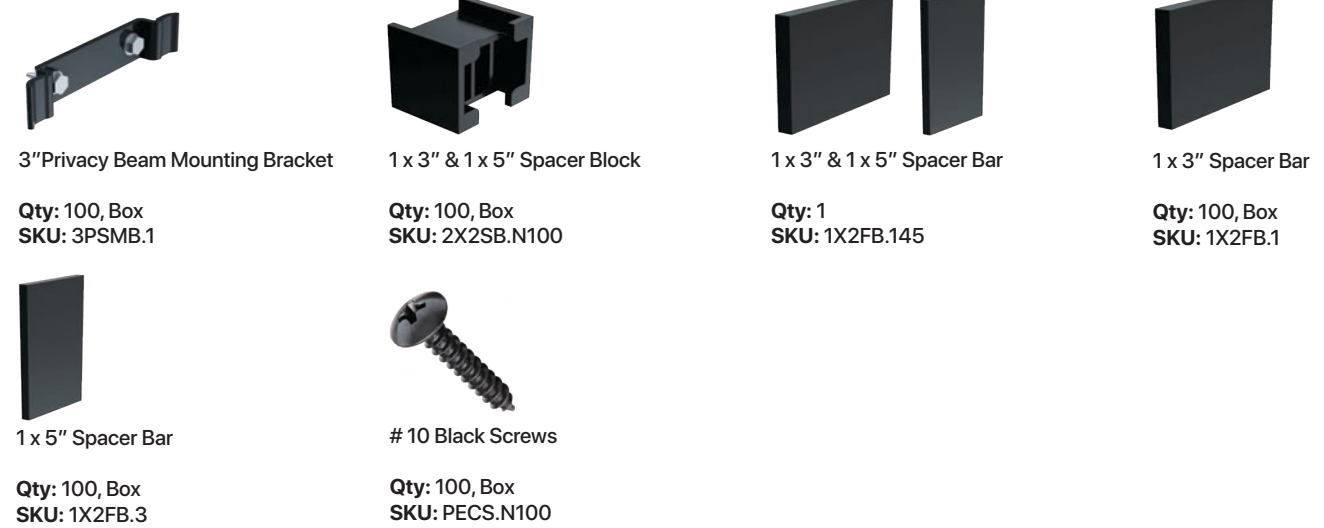

Privacy Beams

Applications: Cladding, Soffit, Screens & Enclosures

Longboard Privacy Beams can be used as stand-alone screening members and can be mechanically fastened to any building structure. Alternatively the beams can also be used within the Longboard Privacy Screen System which is available in a floating or an end-frame configuration to create screens and enclosures.

Privacy beams are available in 1x5 or 1x3 size at 24ft length with thickenings in the side wall to hold mechanical fasteners and come in a wide variety of wood grain, solid colour, and specialty finish options. They are designed to accept matching Longboard end

Technical Specifications

Physical Data
6063-T5 Extruded Aluminum
100% Recyclable
Warranty: Finish: 15 year (standard)/20 year* (ultra) Aluminum: 50 year
Weight (lbs/lf): 0.7 (1X3); 1.1 (1X5)
(*10 week lead time);

caps where needed to create a finished look.
When used as a floating system, single posts are designed to be installed behind the beams anchoring the system to the structure providing a continuous look. The end frame system is designed as a dual-sided application utilizing double posts as intermediate supports with single posts at corners and termination points.

Testing
ICC-ES Evaluation Report - Division: 05 00 00 - METALS
• Section: 05 50 00 - Metal Fabrications
LARR - Los Angeles Department of Building Safety (LADBS) accepts ICC-ES reports as proof of compliance
Florida Building Code: Building
Florida Building Code: Residential

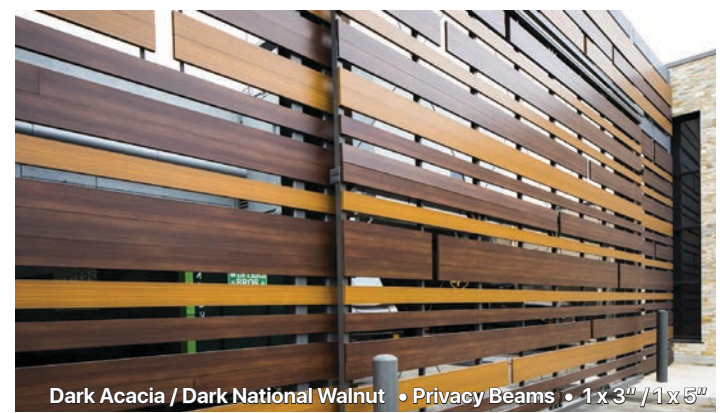
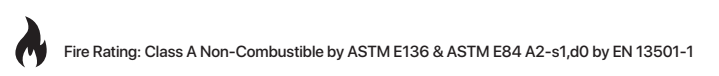

Dark Acacia / Dark National Walnut • Privacy Beams • 1 x 3" / 1 x 5"



Dark National Walnut • Privacy Beams • 1 x 3"

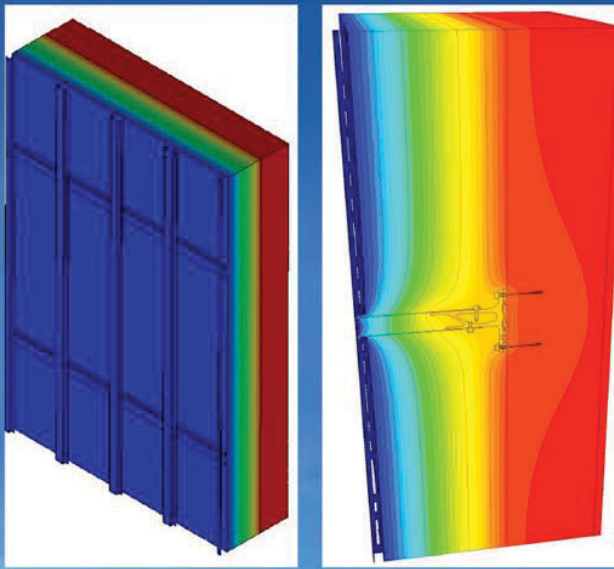

Hitch HD.27 clips

HITCH™

A revolutionary system for rear ventilated facades

Patent Pending - U.S. 17/463,442; U.S. 29/806,153; U.S.

Our Hitch™ cladding attachment system is a patented modular building product for rain screen and exterior wall assemblies offering a thermally broken and intermittent structural solution. Hitch™ is unparalleled when it comes to structural capacity, flexibility, and thermal performance.

Building codes and high-performance energy standards like Passive House and Net-Zero are evolving to meet multiple objectives, including reducing energy consumption and reducing greenhouse gas emissions.

Environmental

LEED – Evaluates a building's environmental performance



The most efficient methods of insulating a building's exterior walls are those that incorporate the principals of continuous exterior insulation with no or minimal thermal bridging to limit thermal loss. Hitch™ can achieve effective R-values exceeding R60 for various types of wall assemblies while supporting heavy cladding loads in high wind load and seismic conditions. The Hitch™ system can accommodate continuous exterior insulation thicknesses between 1" and 16" and is therefore suitable for use in all Passive House and ASHRAE climate zones across North America.

Energy Performance

PASSIVE HOUSE INSTITUTE – Certified Component



HITCH™ SD

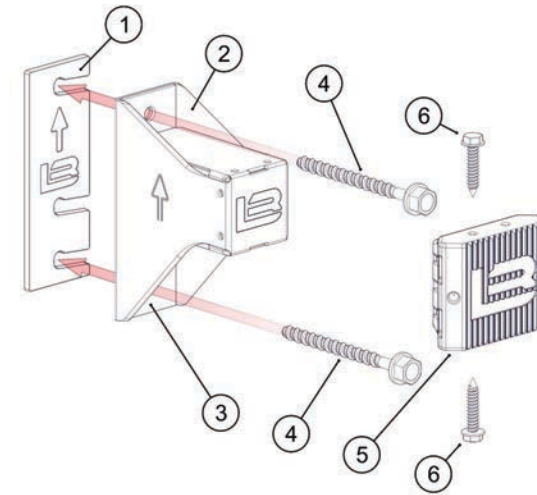

No.	Description	Material	Qty
1	SD Thermal Base Shim	PA6 33% Glass	1
2	SD Clip Base	304 Stainless Steel - 16ga wall	1
3	SD Washer Plate	304 Stainless Steel	1
4	# 14 Fastener	By Others	2
5	Thermal Cap	Injection Molded PA6 33% Glass	1
6	# 10 Sharp Point Hex Head Screw	410 Stainless Steel	2

HITCH™ HD & HD+

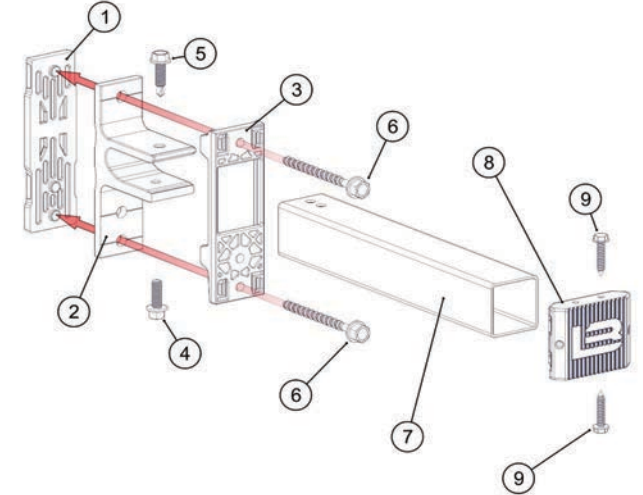

No.	Description	Material	Qty
1	HD Thermal Base	Injection Molded PA6 33% Glass	1
2	HD Clip Base	Extruded 6063 Aluminum Alloy	1
3	HD Thermal Base Cap	Injection Molded PA6 33% Glass	1
4	1/4" - 20 Hex Head Screw	Stainless Steel	1
5	1/4" - 20 Self Drilling Hex Head Screw	Stainless Steel	1
6	# 14 Fastener	By Others	2
7	HD Post Arm	304 Stainless Steel - 16ga wall	1
8	Thermal Cap	Injection Molded PA6 33% Glass	1
9	# 10 Sharp Point Hex Head Screw	410 Stainless Steel	2

Substructure Design Options

Single Layer Girts

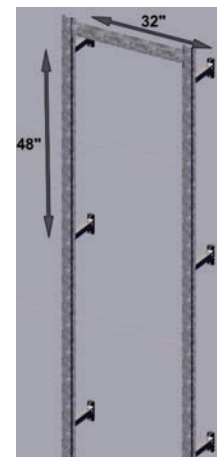

Dual Layer Girts

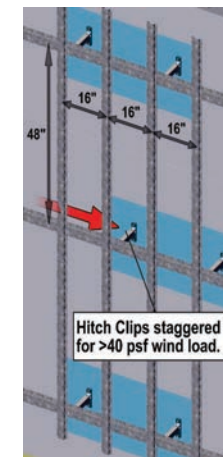

Hitch™ Clip Spacing Consistent, to maintain Thermal Efficiency

Wind Load < 40 PSF using Long-board Planks	Wind Load > 40 PSF using Long-board Planks
Horizontal Cladding Install	Horizontal Cladding Install
Girts Installed Vertically	First Layer girts installed vertically and Second Layer Girts Installed Horizontally



Hitch SD.30 Clips & 1.5" Mineral Wool Insulation

Clips

Please note, clip SKUs and order information are non-exhaustive and for illustrative purposes only. Sample clip sizes are presented that would accommodate a certain exterior insulation thickness. Always consult the Hitch calculator and Longboard technical representatives to verify clip order information.

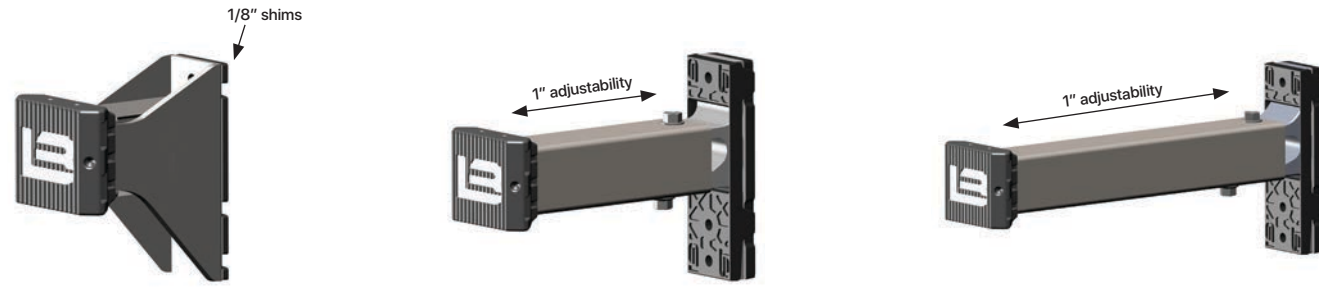

Hitch SD

Insulation Thickness	SKU
1"	HITCH.SD.15
1 1/2"	HITCH.SD.20
2"	HITCH.SD.25
2 1/2"	HITCH.SD.30

Hitch HD

Insulation Thickness	SKU
3"	HITCH.HD.22
4"	HITCH.HD.32
6"	HITCH.HD.52
8"	HITCH.HD.72
10"	HITCH.HD.92
16"	HITCH.HD.152

Hitch HD+

Insulation Thickness	SKU
6"	HITCH.HDP.47
8"	HITCH.HDP.67
10"	HITCH.HDP.87
12"	HITCH.HDP.107
14"	HITCH.HDP.127
16"	HITCH.HDP.147

Installation Accessories

Product	Qty	SKU
Girt Adapter	1	HITCH.GRTADPTR
Girt Connector	1	HITCH.GRTCNCTR
Insulation Piercing Tool	1	HITCH.PRCNGTL
Insulation Plunger Tool	1	HITCH.PLNGRTL
Insulation Piercing Kit	1	HITCH.INSULKIT
SD Thermal Base Shims	48, bag	SDTHBSHM.N48

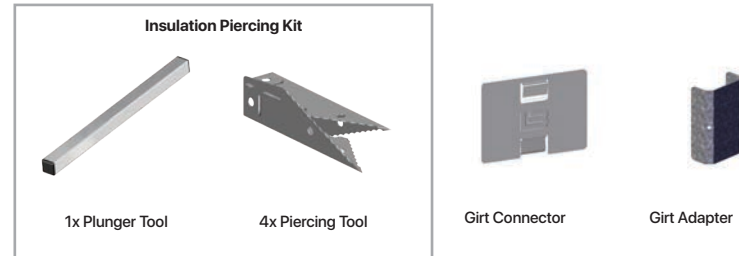

Girts

Depth	Type	72"	96"	120"	144"	192"
3/4"	Standard	-	HITCH.75STDGRT.96	HITCH.75STDGRT.120	HITCH.75STDGRT.144	HITCH.75STDGRT.192
3/4"	Edge	-	HITCH.75EDGGRT.96	HITCH.75EDGGRT.120	HITCH.75EDGGRT.144	HITCH.75EDGGRT.192
3/4"	Corner	HITCH.75CRNGRT.72	-	-	-	-
3/4"	Corner Edge	HITCH.75CRNEDGGRT.72	-	-	-	-
1"	Standard	-	HITCH.1STDGRT.96	HITCH.1STDGRT.120	HITCH.1STDGRT.144	HITCH.1STDGRT.192
1"	Edge	-	HITCH.1EDGGRT.96	HITCH.1EDGGRT.120	HITCH.1EDGGRT.144	HITCH.1EDGGRT.192
1"	Corner	HITCH.1CRNGRT.72	-	-	-	-
1"	Corner Edge	HITCH.1CRNEDGGRT.72	-	-	-	-



Design Assist

We create solutions to meet the needs of your inspiring designs

To truly change the face of architecture, we must not be hindered by limitations of off-the-shelf systems. That's why our product design teams have deep knowledge of buildings sciences and can customize our entire in-house manufacturing process to meet your need.

From custom aluminum extrusions, unique powder coating finishes, value added processing using our CNC metal fabrication capabilities, prefabrication, and modular design solutions, Longboard® is your design assist partner of choice.

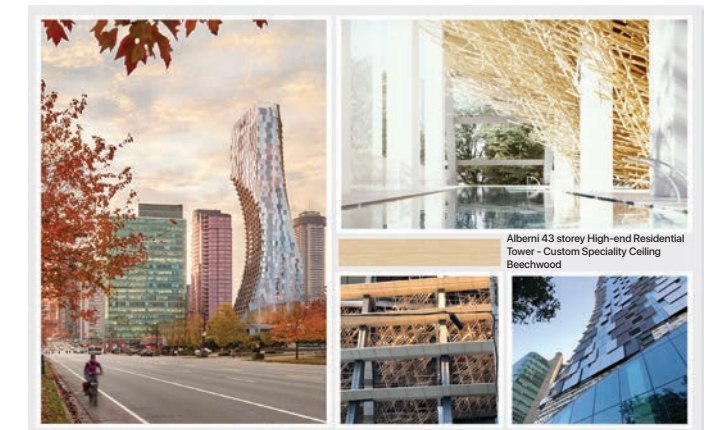
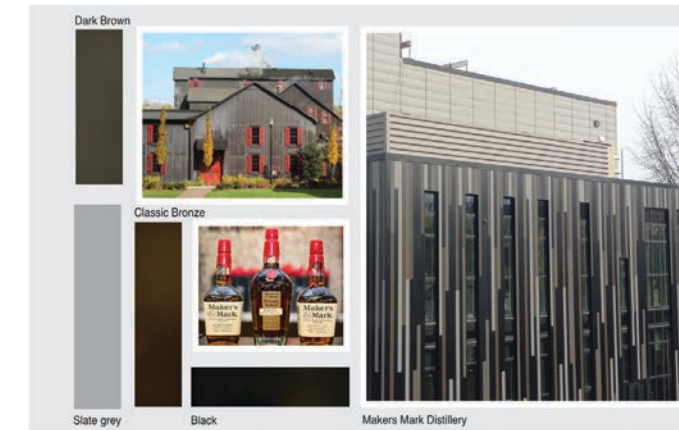

Prefabrication & Modular

We are bent towards action, pursuing innovation, hold core values around continuous improvement and sustainable construction, all of these make prefab and modular construction a natural fit for Longboard. We believe that prefab and modular construction will play an increasingly important role in the future of sustainable construction. Longboard has experience in this field and is actively involved in projects and thought leadership programs to advance prefabrication practices across North America.

Maximizing prefabrication opportunities requires early collaboration and teamwork. Some forms of contracts such as IPD (Integrated Project Delivery) are examples of contractual relationships that can help achieve success on large complex construction projects. We are well versed in the concepts of DFMA (Design for Manufacture and Assembly) and how important it is to keep the manufacturing processes and assembly aspects in mind during the design phases.





Colors & Finishes

Longboard has been applying high performance powder coating and sublimation finishes to extruded aluminum products for nearly 20 years.

Powder coating is a solvent-free (volatile organic compounds or VOC's) dry powder and as a class of coating

Warranties & Certifications

All of our standard manufactured products are covered with our 15 year warranty. This warranty option protects material from checking, cracking, chalking resistance, color retention, gloss retention and adhesion for the first 15 years.

Custom Woodgrains

- Minimum order of 15,000 square feet of material
- \$500 non-refundable setup fee before the matching process begins
- At least two physical samples sent to us. Please speak with our client care team before sending samples
- 2-4 week lead time to have the color matched and receive sample chips
- A sign-off is required on the match to proceed with the order
- Additional lead times to have a custom powder ordered and in our facility are approximately 8 to 12 weeks

generally is considered an environmentally friendly and high-performance finish, particularly in respect to its outstanding toughness and durability. Producing quality painted material is largely dependent on the process used for cleaning the metals, and the chemicals used historically have been chrome or phosphate based.

Products purchased with our 20 year warranty are manufactured differently using a premium powder coating to guarantee longer lasting quality. This warranty option protects material from checking, cracking, chalking resistance, color retention, gloss retention and adhesion for the first 20 years.

Custom Solid Colors

- Minimum order of 1,000 square feet of material
- \$500 non-refundable setup fee before the matching process begins
- At least two physical samples sent to us. Please speak with our client care team before sending samples
- 2 week lead time to have the color matched and receive sample chips
- A sign-off is required on the match to proceed with the order
- Additional lead times to have a custom powder ordered and in our facility are approximately 8 to 12 weeks

Woodgrains

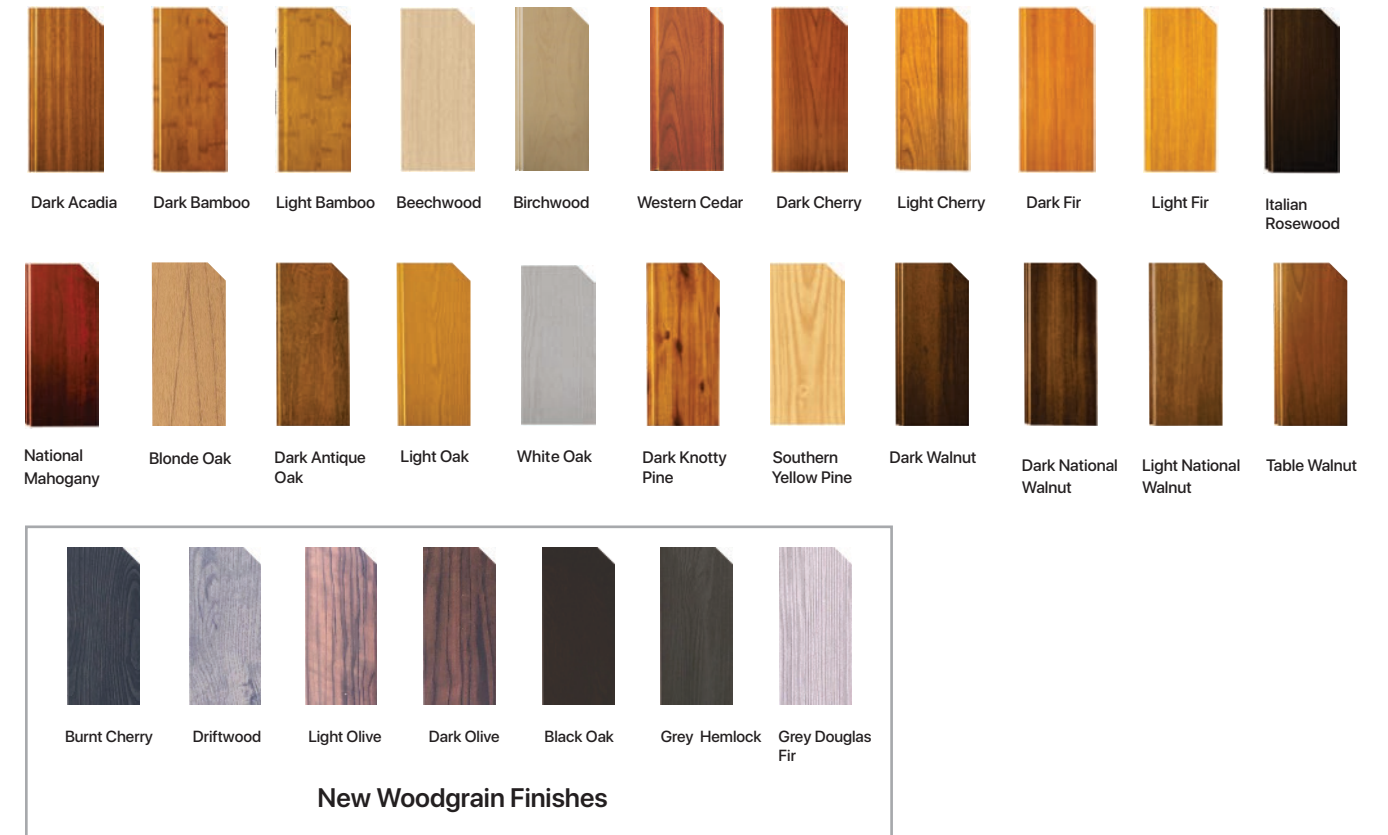

Solid Colors



Speciality



Speciality





LONGBOARD[®]
ARCHITECTURAL PRODUCTS



+1 800 604 0343

Info@longboardproducts.com
Longboardproducts.com